

TRAMIGO

MCPTT-XR

QUICK START GUIDE

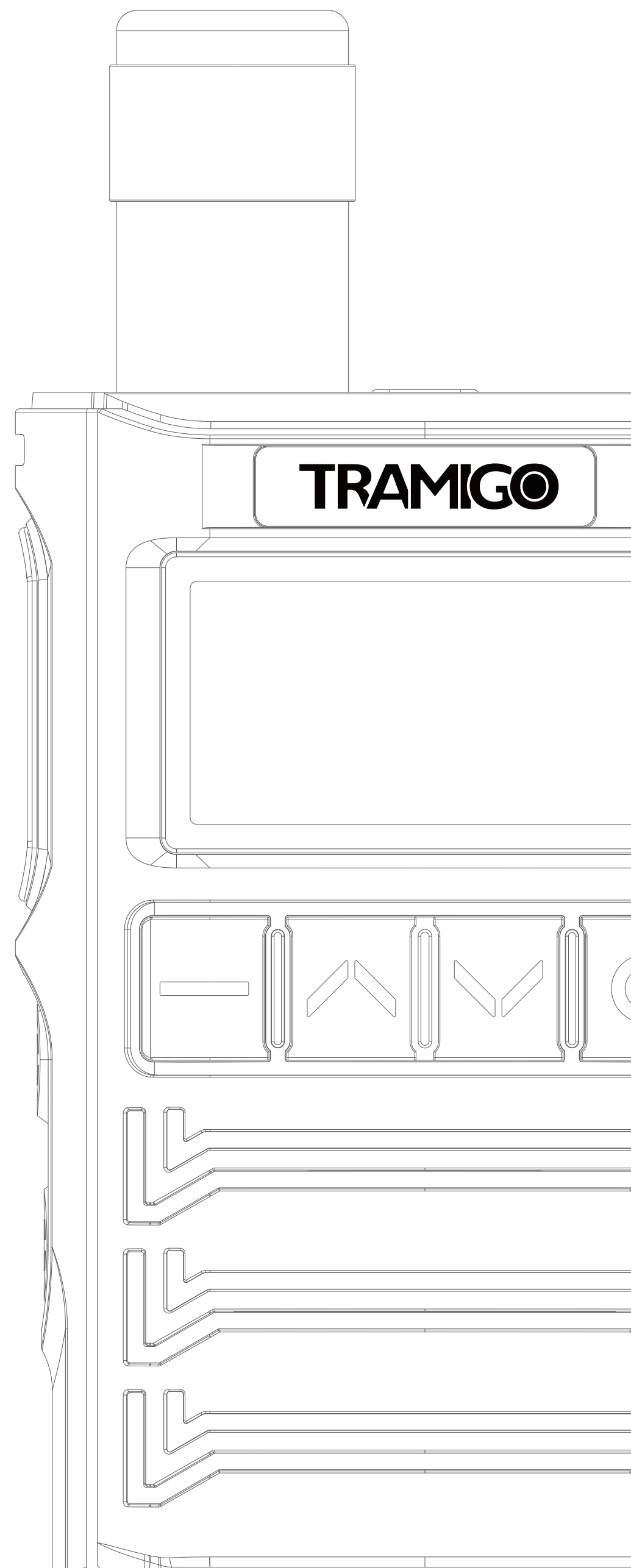

Warning

Safety Notice: Flammable Environments

Switch off the radio completely when operating in flammable or potentially explosive environments, such as areas with gas, dust, vapour, or fog (e.g. petrol stations).

General Information Before Use

Please observe the following instructions to prevent fire, injury, and damage to the device:

- The radio must not be modified, disassembled, or repaired under any circumstances.
- Do not expose the radio to direct sunlight or other heat sources for extended periods.

CONTENTS

Unboxing and Device Inspection	01
Package Contents	01
Installing and Removing Accessories	02
Charging & Storage	02
Installing the Lithium Battery	02
Battery Care	02
Installing the Belt Clip	02
Removing the Belt Clip	02
Getting to Know MCPTT-XR	03
Power On / Off	04
Adjust Volume	04
Push-to-Talk (PTT) Button	04
Group and Member Selection	04
Keyboard Lock / Unlock	04
Playback (Voice Records)	04
Location Information (GPS)	04
Menu Navigation	04
Troubleshooting	05

Unboxing and Device Inspection

Please remove the device carefully from the box. We suggest you check the accessories thoroughly according to our list before discarding the packaging. If any part is missing or damaged when you receive it, please contact Tramigo support.

Package Contents

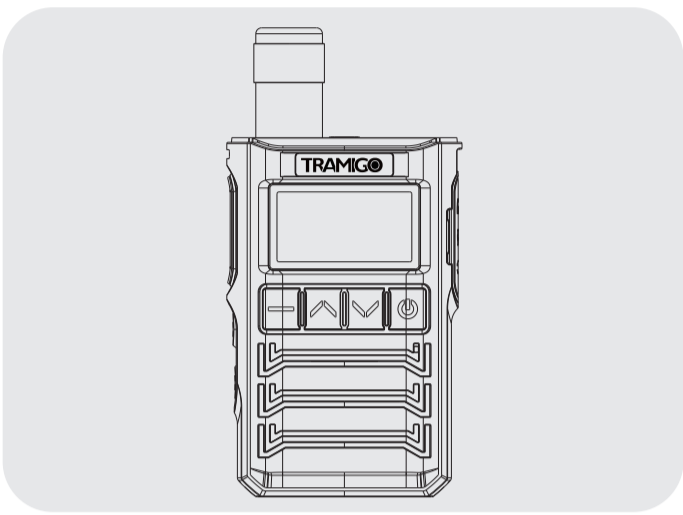

Radio Body*1

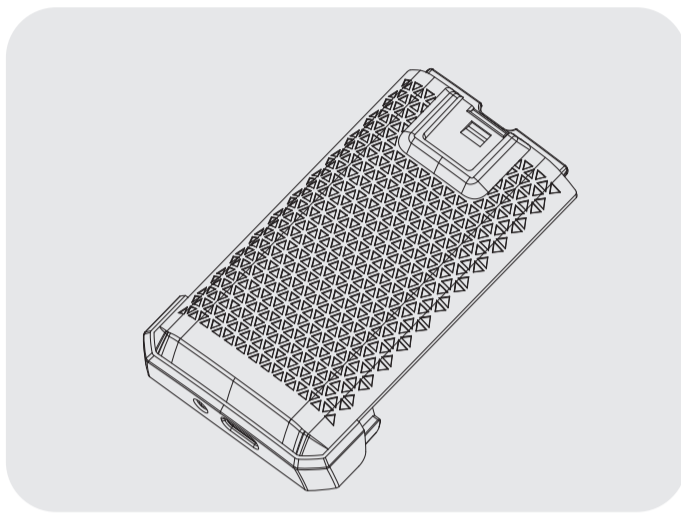

Battery*1

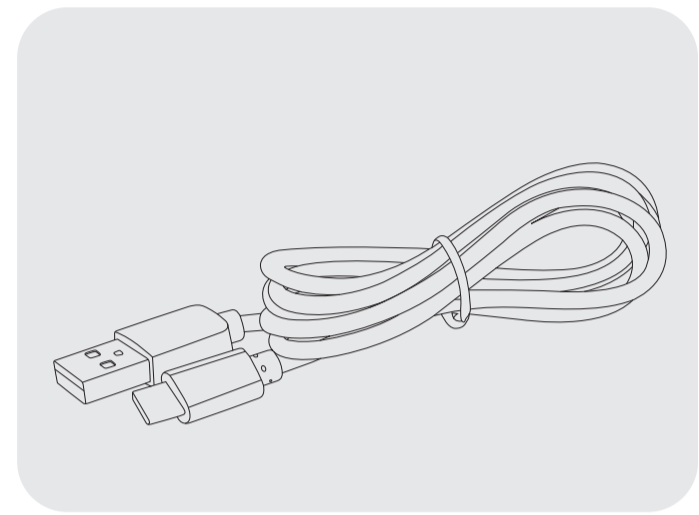

USB-C Cable*1

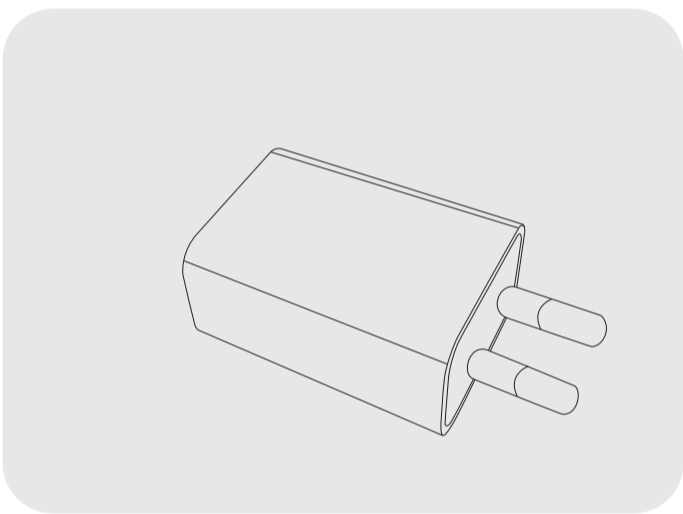

Adapter*1

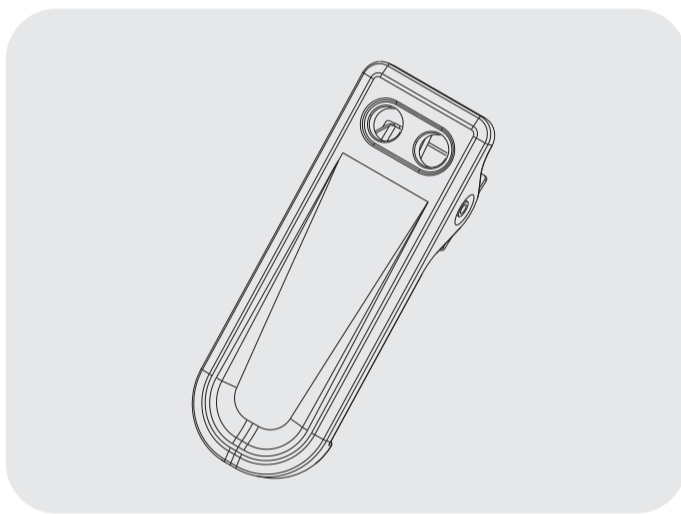

Belt Clip and Screw*1

Preparation Before Use

Warning:

To reduce risk of fire, injury, or damage:

- Use only approved chargers and adapters designed for this device
- Stop charging if it exceeds normal time, as this may cause overheating or fire
- Do not use batteries that show signs of damage (e.g., leakage, deformation, unusual smell)
- Keep damaged batteries away from heat, flames, and flammable materials
- Do not expose batteries to extreme conditions such as high heat, pressure, or enclosed environments (e.g., microwave)

Failure to follow these instructions may result in serious injury or damage.

Installing and Removing Accessories

Battery

Charging & Storage

- Fully charge the battery before first use.
- Remove the battery when not in use and store in a cool, dry place.
- For long-term storage, charge the battery first and keep below 25°C.

Installing the Lithium Battery

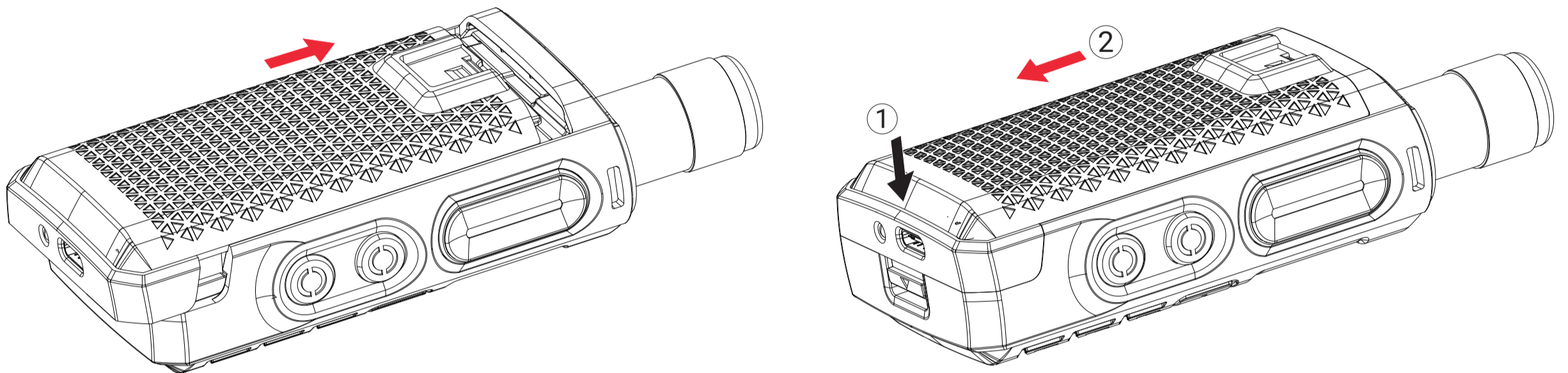

Battery Care

- Battery capacity decreases with use and over time, even when not in use.
- Charging may take longer in low temperatures, while high temperatures can shorten battery life.
- Avoid storing the device in vehicles or near heat sources. If operating time drops significantly, replace the battery to prevent leakage.

Belt Clip

Installing the Belt Clip

Align the belt clip with the slot on the battery pack and insert it until it clicks securely into place.

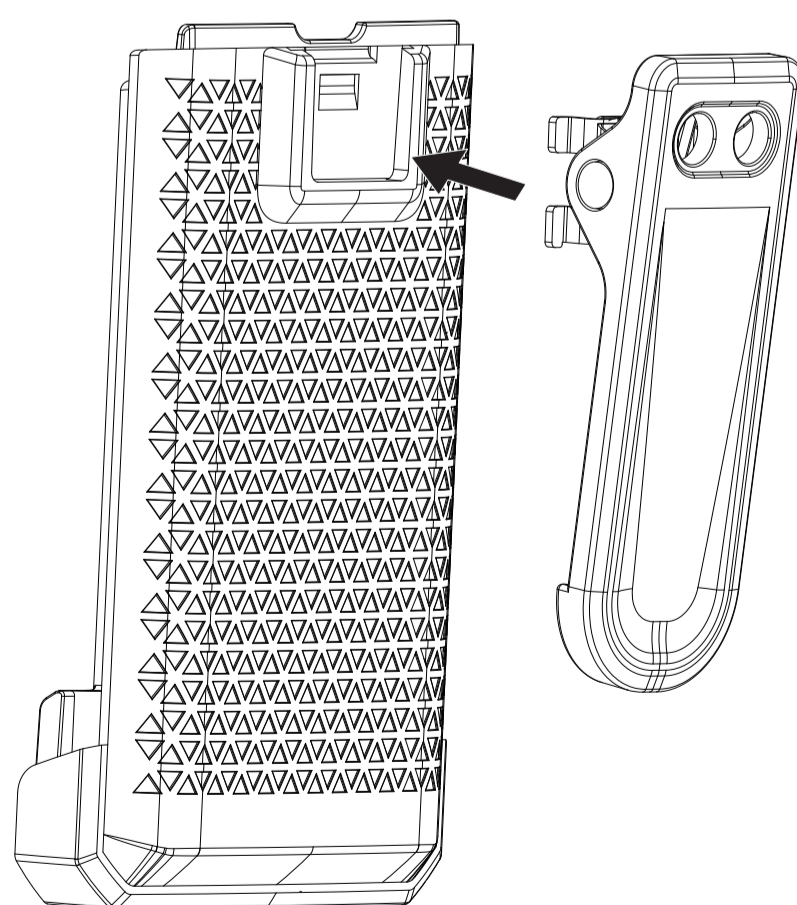

Removing the Belt Clip

Pull the belt clip firmly out of the battery pack slot to remove it.

Getting to Know MCPTT-XR

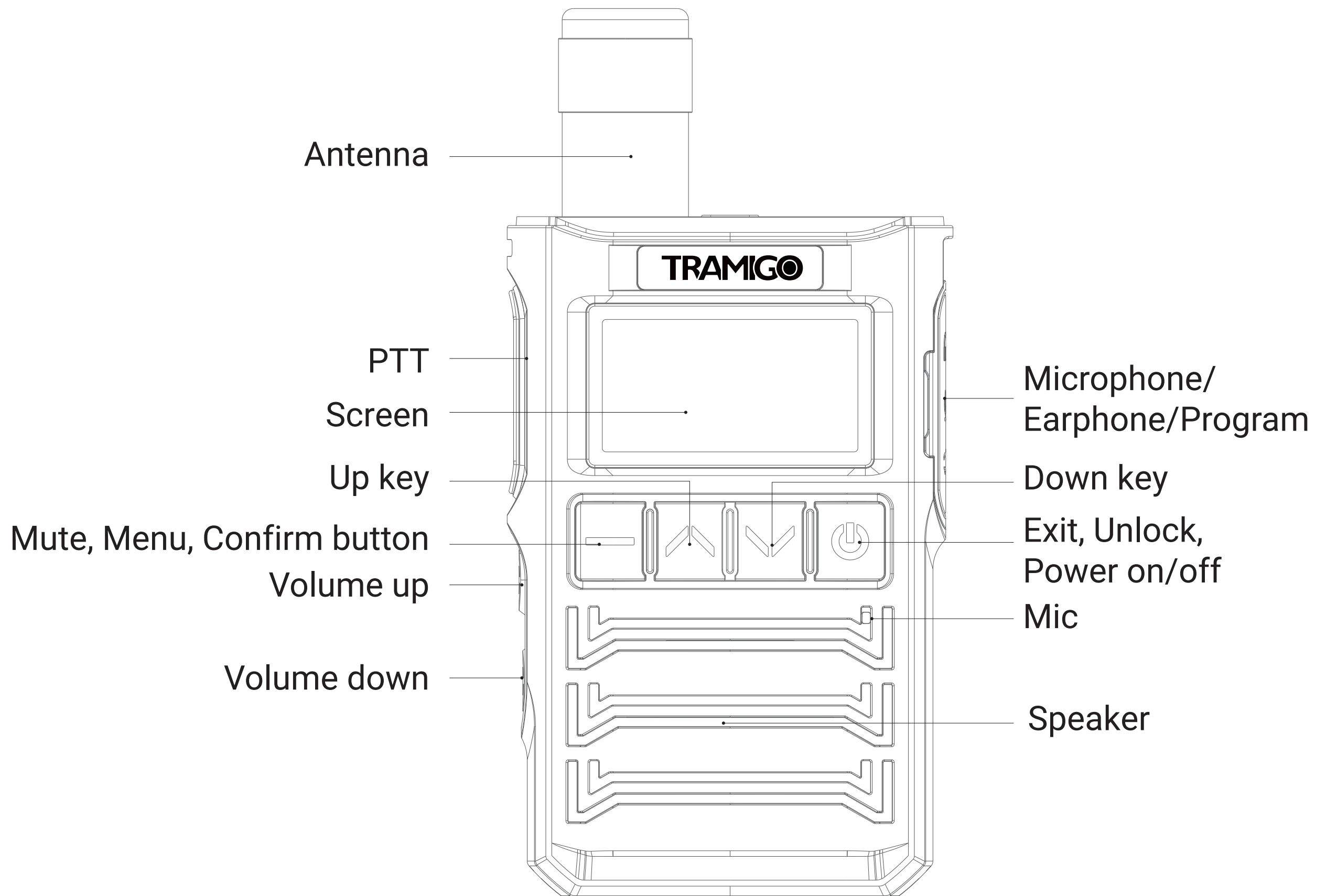

Power On / Off

Press and hold the red Power button for 2 seconds to turn the radio on or off.

Note: If the keypad is locked, unlock it before powering off the device.

Adjust Volume

- Press Volume up key to increase the volume.
- Press Volume down key to decrease the volume.
- Press and hold the green Menu button to mute the radio.

Push-to-Talk (PTT)

- Press and hold the PTT button to speak. The display shows “Transmitting” and the indicator lights red.
- Incoming calls show ID/name (green light).

Group Selection (Group Call)

- Open Menu, choose Group Selection.
- Use the Up / Down keys to select a group.
- Press the Menu button to confirm and switch to the selected group.

Member Selection (One-to-One Call)

- Open Menu, choose Member Selection.
- Use the Up / Down keys to select an available (online) contact.
- Press the Menu button to confirm and start the call.

Keypad Lock / Unlock

- Press and hold the Power button to lock or unlock the keypad.

Playback (Voice Records)

- Press the Menu button and open Settings.
- Select Record and enable voice recording.
- The radio stores the most recent call recording.

Location Information (GPS)

- Use the radio outdoors and wait approximately 1 minute for GPS acquisition.
- When location is enabled, the radio displays the current latitude, longitude, and satellite status.

Menu Navigation

- Unlock the keypad.
- Use the Up / Down keys to navigate the menu.
- Available functions include:
 - Group Selection
 - Member Selection
 - Contact Selection
 - Playback
 - Location Information (GPS)
 - Local Settings

Troubleshooting

- If you experience any of the issues below, follow the guidance provided. If the problem persists, please contact support.

Troubleshooting

If you experience any of the issues below, follow the guidance provided. If the problem persists, please contact support.

Poor Reception

- The signal strength in your current location may be weak, or the network may be busy.
- Move to an area with better coverage or wait briefly before trying again.

Echo or Background Noise

- This may be caused by poor network quality.
- Restart the radio to allow it to automatically connect to a network with better signal quality.

Reduced Battery Life

- This may occur when operating or charging the battery in high-temperature environments.
- Constant network searching in areas with weak coverage can also increase power consumption.
- If signal strength is poor, temporarily switch off the radio when not in use.

Unable to Connect to a Network

- Possible causes include an inactive SIM card, weak signal, or being outside the network coverage area.
- Move to a more open area with better signal reception (e.g. closer to a window or outdoors).

If you have any questions or need assistance, please contact at customercare@tramigo.com